



### The Marlow Range

20ft x 7ft 6' (6.10m x 2.29m)	22ft x 7ft 6' (6.70m x 2.29m)
----------------------------------	----------------------------------

from £43,000	from £44,500
--------------	--------------

Prices are subject to VAT at the applicable rate. If your hut is deemed a habitable space (a bed and kitchen or bathroom) VAT will be applied at 5%

### Price Includes

- Vintage style shepherds hut clad in feather edge oak cladding on a metal box section chassis
- End porch with oak handrail, posts and decking
- Two handmade hardwood windows with double glazed sealed units, sprayed in PU paint finish
- Handmade hardwood single door with double glazed sealed units sprayed in PU paint finish
- Organic, sustainable sheep wool insulation
- Hardwood engineered oak floor
- Feature sawn softwood wall cladding to the interior, finished in Farrow & Ball paint of your choice
- T&G cladding to roof, finished in Farrow & Ball paint of your choice with formers picked out in detail colour
- Kiln dried double width oak steps with solid brass anti slip stud
- Certified electrical package with vintage style fixtures and fittings to compliment your huts

### Optional Hut Additions

### Prices from

3kw Woodburner including slate hearth & powder coated steel black panel (all fitted to HETAS regulations)	£2,700
Electric underfloor heating	£1,900
Shaker style kitchenette	£3,400
Shaker style coffee station	£1000
Additional bespoke shelving and storage	£250
Additional windows	£1,650
Fixed double bed chamber	£3,250
Pull down double bed	£2,800
Bathroom with shower, sink and slimline toilet	£8,000
Exterior shower	£3,600
Water heater	£1,600
Septic tank	£3,700
Delivery & siting of the hut <small>subject to site survey</small>	£2,200

18" Hut

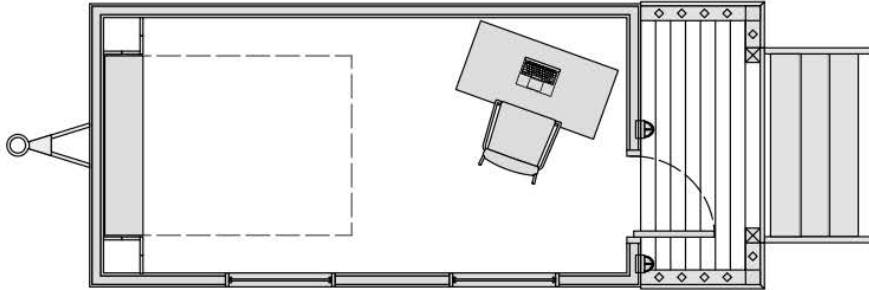

20" Hut

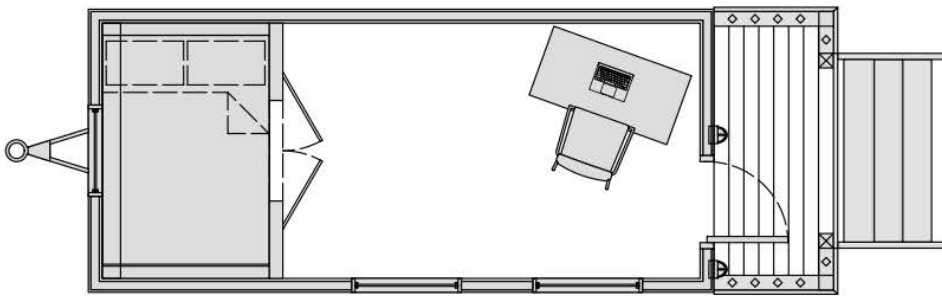

22" Hut

